

CRES-Lock Bands

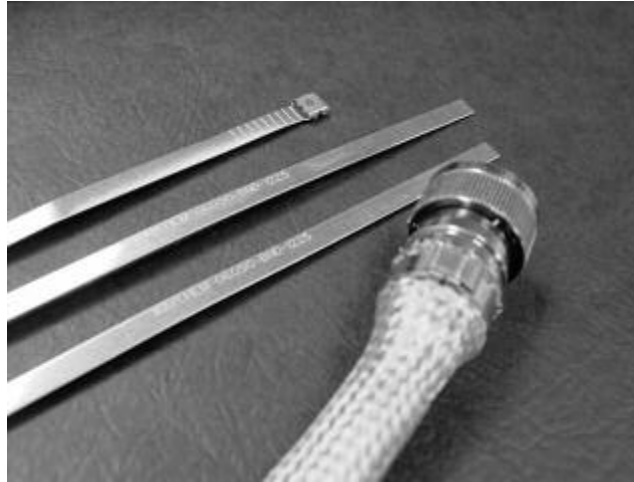

The CRES-Lock (Americas and Asia)/BND (Europe) band strap designator must be specified when using a band adapter. There are two forms of band that are available — precoiled and straight. Straight is a standard configuration and does not require any notation. If precoiled bands

are required, an option P must be used. Refer to CH00-0250-016 drawing for more detailed information. CRES-Lock band strap comes in 12 inch length and BND band strap comes in 14 inch length. These fit all entry sizes for both the CRES-Lock and BND adapter.

Use the band strap designation A in Americas and Asia and B for Europe.

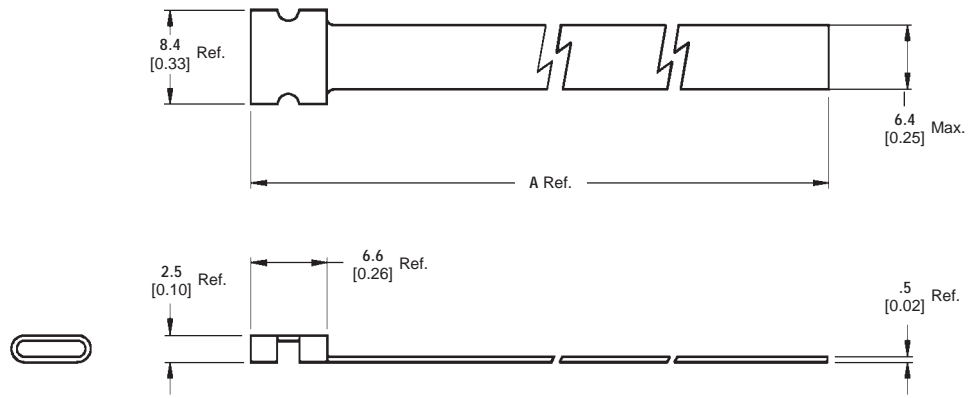

Clamping Band — Straight

Notes:

1. The band is constructed from 300 Series passivated stainless steel and is designed to be installed with either a hand or electric banding tool. Contact Tyco Electronics for further information.
2. The band will be permanently marked with code identification number and full part number (e.g. 06090-BND-1225S).

Part Number	Entry Sizes	A Ref. ±1.5 [±0.06]
BND-1225S	03 to 24	305.0 12.00
BND-1425S	03 to 34	362.0 14.25

Available in:	Americas	Europe	Asia Pacific
	■	■	■